

Date: 2022-05-30
 Enquiry dated:
 Project:
 Quotation-no.:
 Item:
 Reference:

Evaporator (dx) GHN 050.2H/27-ENS50.E For calculation only!

Capacity:	29.1 kW ⁽¹⁾	Refrigerant:	R404A ⁽²⁾
Surface reserve:	-0.2 %	Evaporation temp. (dew point):	-8.0 °C
Air flow:	12840 m ³ /h	Superheating:	5.0 K
Air inlet:	0.0 °C	Condensation temp. (dew pt.):	35.0 °C
Air outlet:	-5.3 °C	Subcooled temp.:	32.6 °C
Air pressure:	1013 mbar		
Fans (AC):	2 Piece(s) 3~400V 50HzY/(-)	Thermal contact:	internal
Data per motor (nominal data):		Noise pressure level:	59 dB(A) in 3.0 m ⁽³⁾
Speed:	1410 min ⁻¹ / (-)	Noise power level:	81 dB(A)
Capacity (mech./el.):	0.49 kW/0.62 kW	Air throw:	approx. 39 m ⁽⁴⁾
Current:	1.45 A ⁽⁵⁾	Frost:	0.0 mm
ErP:	Compliant ⁽⁶⁾		
Total el. power consumption:	1.05 kW	Energy efficiency class:	C (2014)
Casing:	AlMg, Powder coated RAL 9003	 Tubes:	Copper ⁽⁷⁾
Surface:	158.3 m ²	 Fins:	Aluminum ⁽⁷⁾
Tube volume:	42.5 l	 Distr. press. drop:	1.1 bar
Fin spacing:	7.00 mm	 Outlet connection:	54.0 * 2.00 mm
Dry weight:	184 kg ⁽⁸⁾	 Inlet connection:	28.0 mm
Max. operating pressure:	32.0 bar	 PED classification:	Category I, module A ⁽⁹⁾

Dimensions:

- L = 2470 mm
- B = 860 mm
- H = 760 mm
- E = 2000 mm
- F = 700 mm
- C = 240 mm
- A = 550 mm
- ØD = 14 mm
- K = G1¼

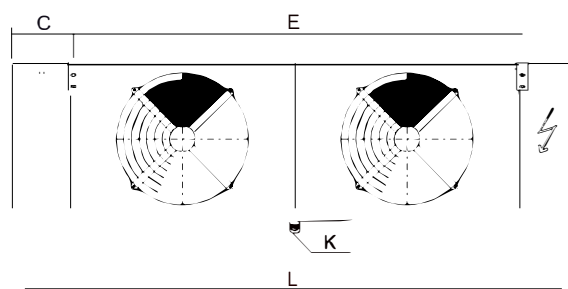
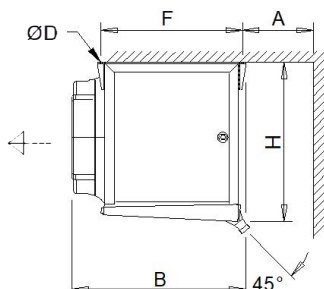

Drain according to DIN ISO 228-1 with G-thread (flat gasket).
 Attention: Drawing and dimensions not valid for all accessory options!

